

TEAM MEMBERS

Name: \_\_\_\_\_  
Address: \_\_\_\_\_  
City: \_\_\_\_\_ State: \_\_\_\_ Zip: \_\_\_\_\_  
Phone: \_\_\_\_\_  
E-mail: \_\_\_\_\_  
☐ Attending Thursday Evening Social

Name: \_\_\_\_\_  
Address: \_\_\_\_\_  
City: \_\_\_\_\_ State: \_\_\_\_ Zip: \_\_\_\_\_  
Phone: \_\_\_\_\_  
E-mail: \_\_\_\_\_  
☐ Attending Thursday Evening Social

Name: \_\_\_\_\_  
Address: \_\_\_\_\_  
City: \_\_\_\_\_ State: \_\_\_\_ Zip: \_\_\_\_\_  
Phone: \_\_\_\_\_  
E-mail: \_\_\_\_\_  
☐ Attending Thursday Evening Social

Name: \_\_\_\_\_  
Address: \_\_\_\_\_  
City: \_\_\_\_\_ State: \_\_\_\_ Zip: \_\_\_\_\_  
Phone: \_\_\_\_\_  
E-mail: \_\_\_\_\_  
☐ Attending Thursday Evening Social

Please provide any additional team member's information on a separate document and include with this registration form. \*Tee time confirmations will be sent via email



**JBG Foundation special events are held rain or shine. Because this is a charitable event, no refunds will be made if it becomes impossible to complete the event due to adverse weather or circumstances beyond the event committee's control.**

THE COMMUNITY WINS TOO!

The JB Griffin Memorial Foundation was formed in 2012, in memory of and to honor the life of our friend and colleague, JB Griffin, the Chief Financial Officer of Shaner Corp.

JB was a loving husband and father of five children who in August 2011, lost his battle with cancer and Shaner lost a great mentor to all fellow associates.

The JB Griffin Memorial Foundation is a non-profit 501(c)(3) organization formed to provide financial support to charitable organizations that assist people in need in the communities in which Shaner does business. Working in conjunction with the annual Golf Classic, the Foundation will serve as the beneficiary of the tournament proceeds and will disburse funds to qualified charities throughout the community.

The JB Griffin Memorial Foundation will direct the proceeds to the State of Hope Foundation. The State of Hope Foundation was founded in State College, PA by Nathan and Marissa Stupar, in 2016 and has set out to provide children of low income families, single parents, and other less fortunate situations with positive life experiences that they may not be able to obtain otherwise. Although founded in State College, PA, The State of Hope Foundation intends to expand its reach and welcomes any opportunities to carry out its mission statement globally.

We thank each and every one of you who have and will donate to this wonderful cause. Without your generous efforts we would not be able to help as many children as we do! For more information please visit <https://stateofhopefoundation.org>.

The Foundation will also provide additional funding to Cancer Survivors' Association, House of Care, ACRES Project and Discovery Space. For more information about these organizations please visit:

- [www.cancersurvive.org](http://www.cancersurvive.org)
- [www.houseofcare.org](http://www.houseofcare.org)
- <https://acresproject.org>
- <https://discoveryspace.org>

We encourage 501(c)(3) organizations in Centre County, Pa to apply for funding. To learn more about the Foundation and to obtain an application, please visit [www.jbgriffinfoundation.com](http://www.jbgriffinfoundation.com).

Due to COVID-19, the JB Griffin Memorial Foundation will divide funding between 2020 and 2021. All organizations listed will remain recipients for 2021.

THURSDAY SOCIAL INFO/LOCATION

The social will feature heavy appetizers from The Field, Wine and Scotch tasting and cigars. See below for a map referencing the social location in the Aspen Retreat/Aspen Room at Toftrees Golf Resort. All guests must pre-pay online at [www.jbgriffinfoundation.com](http://www.jbgriffinfoundation.com).

Thursday Dinner Guest(s) # \_\_\_\_\_ @ \$25 per guest

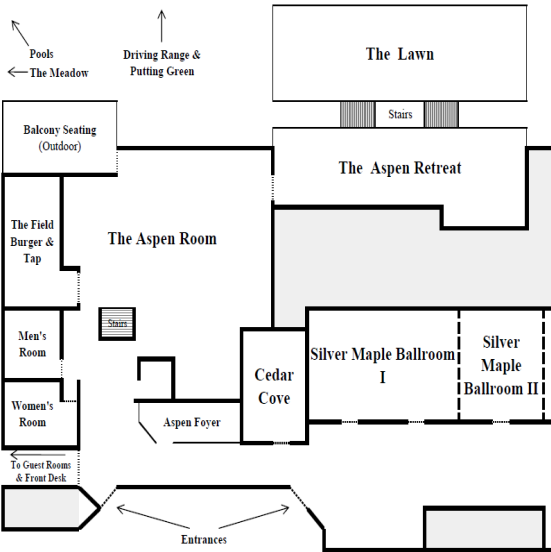

TOFTREES GOLF RESORT  
STATE COLLEGE, PA

SCHEDULE OF EVENTS

THURSDAY, AUGUST 13TH
8:00am Tee Times Start—Every 10 Minutes
Registration at #1 Tee at start of the round
7:00pm—10:00pm Social held at the Aspen Retreat/ Aspen Room @ Toftrees Golf Resort
7:00pm—10:00pm Glow in the dark closest to the pin contest on Hole #10 (weather permitting)
FRIDAY, AUGUST 14TH
8:00am Tee Times Start—Every 10 Minutes
Registration at #1 Tee at start of the round
*There will be no post golf dinner event

Tee Time Shamble Format

The tournament will be tee time based every 10 minutes and features a shamble format. All golfers tee off, you select the best shot, then everyone plays their own ball for the rest of their hole. Will use two best scores of the foursome. Each team consists of four players and need to be at least 21 years of age. Each day will be limited to approximately 172 golfers.

Meals

Meals will be available in To Go Boxes for morning snack, lunch and afternoon snack.

Team and Individual Prizes

1st Place	3rd Place
2nd Place	20th Place

Prizes will be awarded for each Thursday and Friday round of golf for the Longest Drive (men’s and ladies), Closest to the Pin (men’s and ladies) and the above team prizes.

Awards & Prizes

After the round of golf each day, the awards and prizes will be announced via recorded video and will be shared post tournament as part of the thank you message this year. All prizes will be mailed to the individuals home.

Mobile Pro Shop

Located in the parking lot, golfers will be able to select a gift with their Mobile Pro Shop credit ticket before or after their round of golf.

SPONSOR RESERVATIONS

<b>MASTERS</b>	<b>\$25,000</b>
<b>Tournament Sponsor (1)</b>	
<ul style="list-style-type: none"><li>12 golfers &amp; meals</li><li>6 rooms for August 13th or 14th</li><li>Bonus Gift (extra \$50 MPS credit)</li><li>Recognition on all printed materials for the event</li><li>#10 TEE Hole Sponsor (sign included)</li><li>#10 Hit the Green for Kids! \$10 for each golfer that hits the green will be moved to a scholarship fund in the tournament sponsors name</li><li>Large banner to hang at the course (sponsor to provide)</li></ul>	
<b>ALBATROSS</b>	<b>\$12,500</b>
<b>Golfer Gift Sponsor (2—1 on Thurs &amp; 1 on Fri)</b>	
<ul style="list-style-type: none"><li>8 golfers &amp; meals</li><li>4 rooms for August 13th or 14th</li><li>Bonus Gift (extra \$50 MPS credit)</li><li>Recognition on all printed materials for the event</li><li>#9 TEE Hole Sponsor (sign included)</li><li>Gift Sponsor Sign at registration (sign included)</li></ul>	
<b>EAGLE</b>	<b>\$10,000</b>
<b>Meals Sponsor (2—1 on Thurs &amp; 1 on Fri)</b>	
<ul style="list-style-type: none"><li>8 golfers &amp; meals</li><li>4 rooms for August 13th or 14th</li><li>Bonus Gift (extra \$25 MPS credit)</li><li>Recognition on all printed materials for the event</li><li>#1 TEE Hole Sponsor (sign included)</li><li>Breakfast, Lunch &amp; Dinner Sponsor Sign (sign included)</li></ul>	
<b>BIRDIE</b>	<b>\$7,500</b>
<b>Scorecard and Prize Sponsor (2—1 on Thurs &amp; 1 on Fri)</b>	
<ul style="list-style-type: none"><li>8 golfers &amp; meals</li><li>2 rooms for August 13th or 14th</li><li>Bonus Gift (extra \$25 MPS credit)</li><li>Recognition on all printed materials for the event</li><li>#18 TEE Hole Sponsor (sign included)</li><li>Sponsor Logo on ALL Scorecards on golf carts</li><li>Sponsor Sign at Prize Table (sign included)</li></ul>	

ADDT’L SPONSOR RESERVATIONS

<b>PAR</b>	<b>\$5,000</b>
<b>Beverage Sponsors (2—1 on Thurs &amp; 1 on Fri)</b>	
<ul style="list-style-type: none"><li>Recognition on all printed materials for the event</li><li>Sponsor Sign on Beverage Cart (sign included)</li></ul>	
<b>BOGEY</b>	<b>\$2,500</b>
<b>Golf Cart Sponsor (2—1 on Thurs &amp; 1 on Fri)</b>	
<ul style="list-style-type: none"><li>4 Golfers &amp; meals</li><li>Recognition on all printed materials for the event</li><li>Hole Sponsor (sign included)</li><li>Sponsor Logo on ALL Golf Cart Name Cards</li><li>Ability to promote/advertise to golfers with materials in carts</li></ul>	
<b>DOUBLE BOGEY</b>	<b>\$1,000</b>
<b>Foursome Hole Sponsor Package (15)</b>	
<ul style="list-style-type: none"><li>4 Golfers &amp; meals</li><li>Hole Sponsor (sign included)</li></ul>	
<b>TRIPLE BOGEY</b>	<b>\$500</b>
<b>Hole Sponsor (multiple)</b>	
<ul style="list-style-type: none"><li>Tee/Green Sponsor Sign</li></ul>	
<b>ONE PUTT</b>	<b>\$175</b>
<b>Individual Golf Entry Fee (multiple)</b>	
<ul style="list-style-type: none"><li>Sign up as an individual, twosome, threesome or foursome</li></ul>	
<b>FRIENDS OF THE FOUNDATION</b>	<b>\$100</b>
<b>Donation to JB Griffin Classic</b>	
<ul style="list-style-type: none"><li>If you are unable to attend but want to contribute, JB Griffin Memorial Foundation will be accepting individual donations/support</li><li>Minimum \$100 donation</li></ul>	
<b>NEED ROOM RESERVATIONS</b>	
<i>SPECIAL RATE VALID AUGUST 13TH &amp; 14TH ONLY—Rates @ \$109</i>	
<i>*If you are a sponsor who receives rooms with the sponsorship, please email <a href="mailto:mbartley@shanercorp.com">mbartley@shanercorp.com</a>*</i>	
If you choose to contact the hotel, please reference the Golf Tournament Room Block	
CLICK ON A HOTEL BELOW TO RESERVE YOUR ROOM. FIRST COME FIRST SERVE.	
<i><a href="#">State College Holiday Inn Express</a> or Call 814-867-1800</i>	
<i><a href="#">State College Hampton Inn &amp; Suites</a> or Call 814-231-1899</i>	
<i><a href="#">State College Fairfield Inn &amp; Suites</a> or Call 814-238-3871</i>	
<i>Cut off to reserve is July 30th</i>	

REGISTRATION & PAYMENT

Information: Deadline for entry: July 31, 2020

Name: \_\_\_\_\_

Company: \_\_\_\_\_

Address: \_\_\_\_\_

City: \_\_\_\_\_ State: \_\_\_\_ Zip: \_\_\_\_\_

Phone: \_\_\_\_\_

E-mail: \_\_\_\_\_

Thursday preference:

\*Every 10 Minutes\* Write in Your Preferred Time\*

_____	8:00A.M.—8:50A.M. tee time
_____	9:00A.M.—9:50A.M. tee time
_____	10:00A.M.—10:50A.M. tee time
_____	11:00A.M.—11:50A.M. tee time
_____	12:00P.M.—12:50P.M. tee time
_____	1:00P.M.—1:50P.M. tee time
_____	2:00P.M.—2:50P.M. tee time
_____	3:00P.M. tee time

Friday preference:

\*Every 10 Minutes\* Write in Your Preferred Time\*

_____	8:00A.M.—8:50A.M. tee time
_____	9:00A.M.—9:50A.M. tee time
_____	10:00A.M.—10:50A.M. tee time
_____	11:00A.M.—11:50A.M. tee time
_____	12:00P.M.—12:50P.M. tee time
_____	1:00P.M.—1:50P.M. tee time
_____	2:00P.M.—2:50P.M. tee time
_____	3:00P.M. tee time

***DUE TO THE NUMBER OF TEAMS, WE WILL NOTIFY YOU IF YOUR REQUESTED START TIME IS NOT AVAILABLE.***

To reserve your place in the tournament, register and pay by credit card online @ [www.jbgriffinfoundation.com](http://www.jbgriffinfoundation.com) or send check (payable to JB Griffin Memorial Foundation) with registration.

**JB Griffin Memorial Foundation**  
**Attn: Mandy Hartley**  
**1965 Waddle Road, State College, PA 16803**

Questions? Contact us: TEL: (814) 278-7247  
E-MAIL: [mhartley@shanercorp.com](mailto:mhartley@shanercorp.com)  
**Please list all participants on back.**